

**ITEM 38. PARKING – TIMED PARKING – HADFIELDS STREET
ERSKINEVILLE**

TRIM RECORD NO: 2017/307884

RECOMMENDATION

It is recommended that the Committee endorse the following kerbside changes in Hadfields Street, Erskineville (i.e. a new road):

- (A) Eastern side, between the points 12.4 metres and 68 metres (seven car spaces) north of Coulson Street, as “2P 8am-10pm”;
- (B) Eastern side, between the points 83.4 metres and 96 metres (nine car spaces) north of Coulson Street, as “2P 8am-10pm”;
- (C) Eastern side, between the points 99 metres and 105.3 metres (one car space) north of Coulson Street, as “No Parking” for a future car share space;
- (D) Eastern side, between the points 105.3 metres and 153.7 metres (six car spaces) north of Coulson Street, as “2P 8am-10pm”;
- (E) Eastern side, between the points 155.7 metres and 169.1 metres north of Coulson Street, as “No Stopping”;
- (F) A “Give Way” control across the intersection of Hadfields Street with Coulson Street; and
- (G) A yellow “No Stopping” line on the western and eastern sides along all kerb space that is not indented.

VOTING MEMBERS FOR THIS ITEM

<i>Voting Members</i>	<i>Support</i>	<i>Object</i>
City of Sydney		
Roads and Maritime Services		
NSW Police – Redfern LAC		
Representative for the Member for Heffron		

DECISION

BACKGROUND

The Development Consent for 1-15/1A Coulson Street, Erskineville (D/2015/865) requires the Applicant to deliver a new road known as “Hadfields Street”, between Coulson and Macdonald Streets. At the completion of the works, the new road will be dedicated to the City.

The delivery of the new road will address Condition 114 and 115 for 1-15/1A Coulson Street, Erskineville. In addition, Condition 30 requires the Applicant to submit a signage plan for kerbside parking and line marking arrangements that is to be referred to the Local

Pedestrian, Cycling and Traffic Calming Committee, as part of the dedication of “Hadfields Street” as a public road.

COMMENTS

The Ashmore Precinct, bounded by Ashmore Street, Mitchell Road, Coulson Street and Bankstown Railway Line will include a new two-way north-south aligned road, to be known as “Hadfields Street” which will connect Coulson and Macdonald Streets.

The City has approved the redevelopment of 1-15/1A Coulson Street, Erskineville which includes the construction of Hadfields Street, between Coulson and Macdonald Streets, as a new public road.

The new road is a two-way street, 5.8 metres wide with on-street parking provided in indented bays along the eastern kerb. No on-street parking will be provided along the western kerb.

Parking within the indented bays will be signposted with timed parking restrictions i.e. “2P 8am-10pm” which are in line with the City’s Neighbourhood Parking Policy and is the same as the existing restrictions in nearby completed streets. These restrictions will provide parking turnover and availability of short term parking for visitors to the area.

A two-hour parking limit is preferred for streets in the inner residential areas as it better balances the long-stay parking needs of all households to use parking for visitors, family, carers and tradespeople.

One parking space in the indented bays will be signposted as “No Parking” in order to preserve the space until a submission is received by a car share operator. Once a submission is received the “No Parking” space will be reallocated as “No Parking Car Share Vehicles Excepted”.

The kerb space outside the indented parking bays will have yellow line marking to indicate a “No Stopping” restriction.

Hadfields Street will form a temporary dead-end until the completion of Macdonald Street as part of adjacent development sites. Therefore the northernmost indented bay on the eastern side of Hadfields Street will be signposted as “No Stopping” to create a temporary turning area. The temporary turning area will allow vehicles to turn around in Hadfields Street and travel south back to Coulson Street, until the completion of Macdonald Street. Once traffic access is available from Hadfields Street into Macdonald Street, the “No Stopping” signs in the temporary turning area will no longer be required and will be reallocated as “2P 8am–10pm” as per the adjacent indented bays.

CONSULTATION

Consultation with affected stakeholders was undertaken as part of the Development Application process for 1-15/1A Coulson Street, Erskineville.

FINANCIAL

All costs associated with the proposal will be borne by the Applicant.

ATTACHMENTS

Parking – Timed Parking – Hadfields Street Erskineville

James Nguyen, Engineering Traffic Officer

A.L.	G.S.	N.M.
DESIGNER	CHECKED	APPROVED

IR	DATE	DESCRIPTION
1	23.05.2017	TRAFFIC COMMITTEE REVIEW

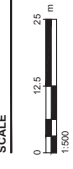

- LEGEND:**
- ONEA SITE TITLE BOUNDARY
 - - - ONEA FUTURE SITE BOUNDARY
 - . - . - ASHMORE PRECINCT BOUNDARY
 - - - - - ASHMORE PRECINCT BOUNDARY
 - - - - - EXISTING SITE BOUNDARY
 - ▭ SITE AREA

NOTE:

- PROJECT BOUNDARIES BASED ON SURVEYING SOLUTIONS REFER FILE TSS_8009(00)_VPA_SURVEY TOPOGRAPHICAL SURVEY PROVIDED BY BROWN SMART CONSULTING DATED 14-10-2014. REFER 'X' IN '14213-SURVEY.DWG'

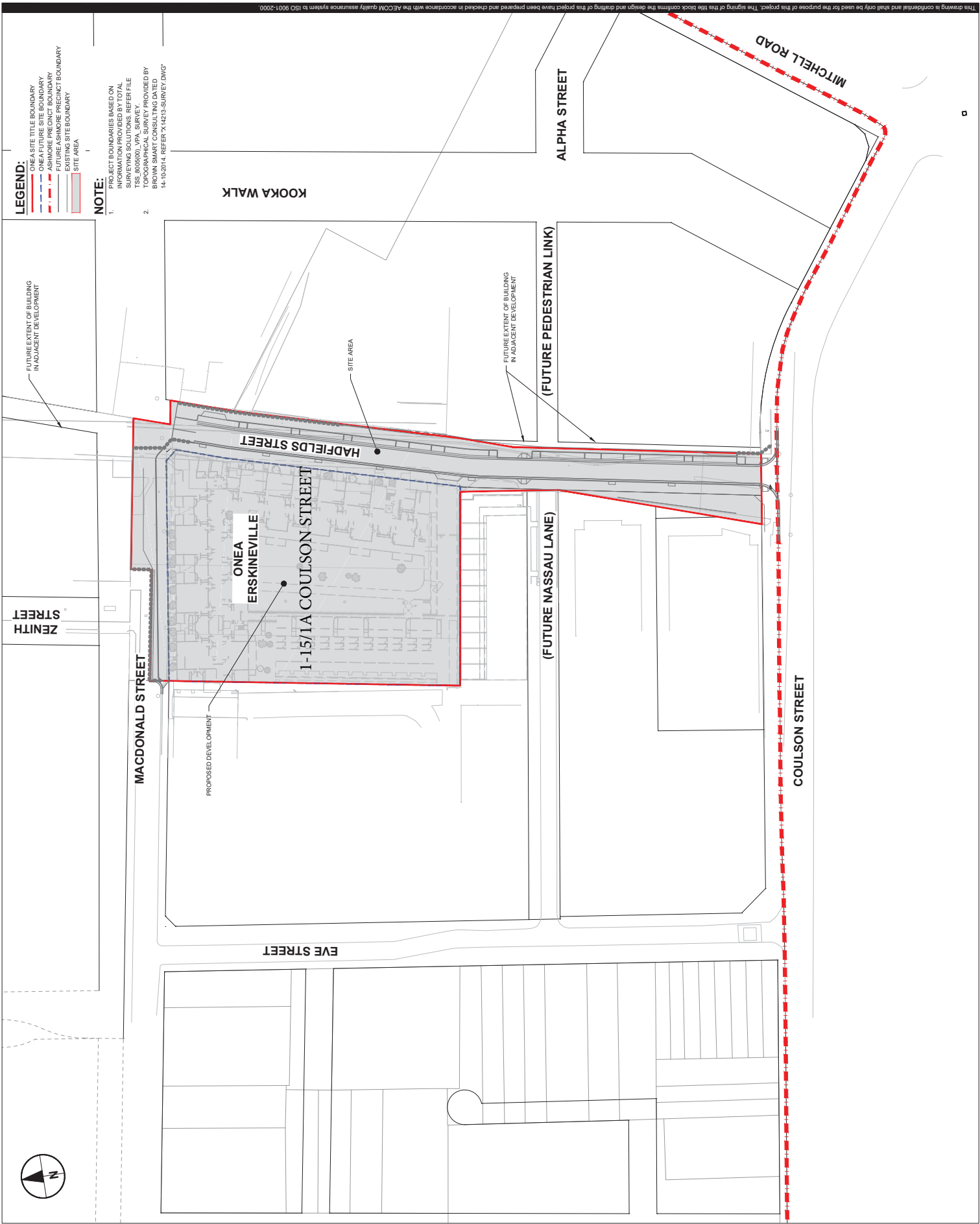

PROJECT MANAGEMENT INITIALS		
A.L.	G.S.	N.M.
DESIGNER	CHECKED	APPROVED

ISSUE/REVISION		
NO.	DATE	DESCRIPTION
5	21.09.2017	TRAFFIC COMMITTEE REVIEW
4	21.09.2017	TRAFFIC COMMITTEE REVIEW
3	20.09.2017	TRAFFIC COMMITTEE REVIEW
2	20.09.2017	TRAFFIC COMMITTEE REVIEW
1	20.09.2017	TRAFFIC COMMITTEE REVIEW

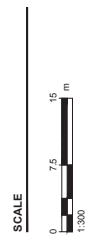

PROJECT NUMBER

SHEET TITLE
TRAFFIC COMMITTEE
SIGNS AND LINES PLAN

SHEET NUMBER
60518617-SKE-00-0000-CH-0006

